

Typical Upper/Lower Control Arm Installation Instructions

(Click on picture of part to purchase.)

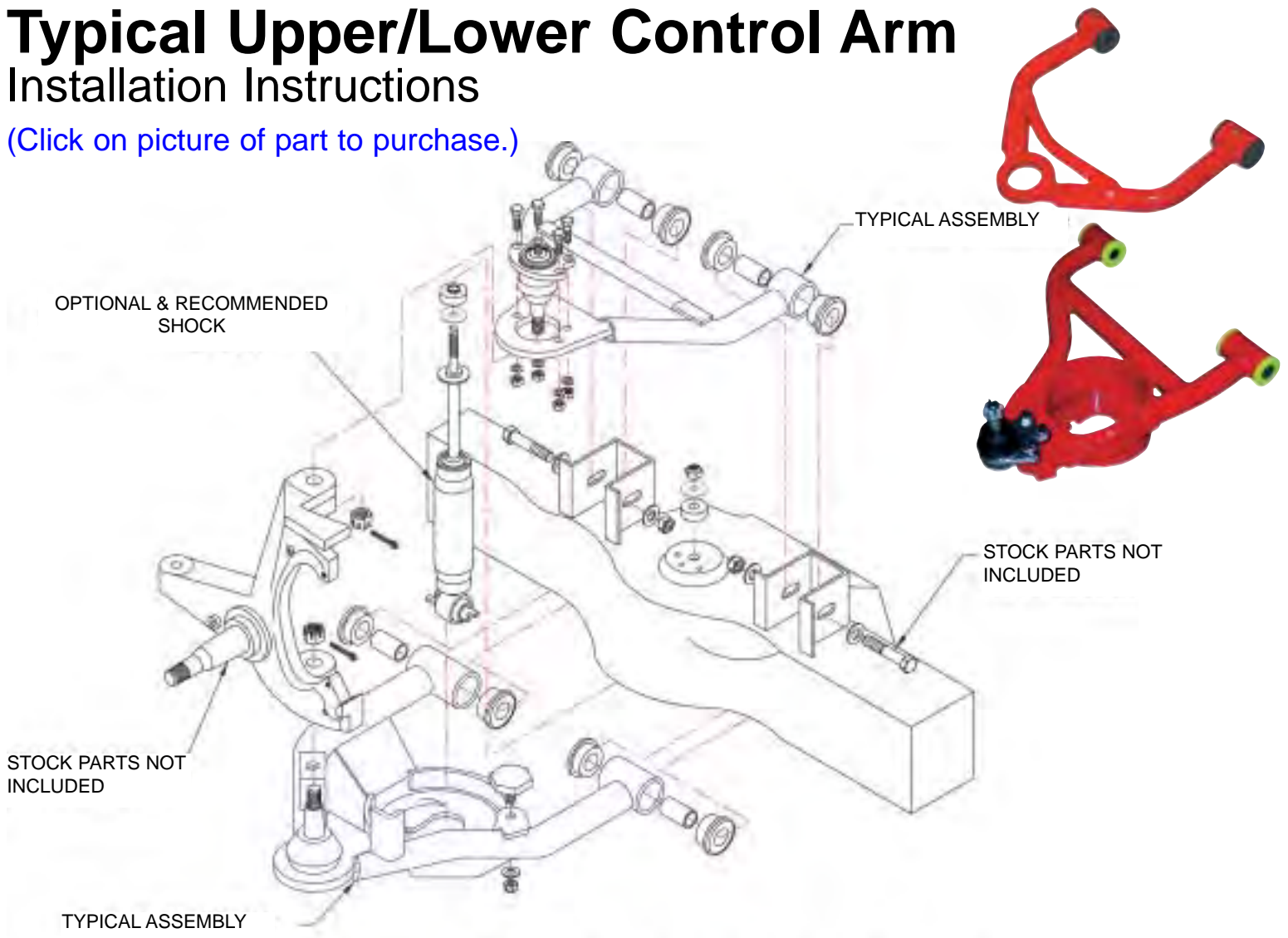

1. ONCE JACK STANDS ARE PLACED UNDER THE FRAME REMOVE THE FRONT TIRES . REMOVE THE COTTER PIN THE THE TIE ROD END. LOOSEN NUT AND REMOVE.

PLACE FLOOR JACK UNDER LOWER CONTROL ARM FOR SUPPORT. REMOVE COTTER PINS FROM THE LOWER AND UPPER BALL JOINTS.

3.LOOSEN BALL JOINT NUTS ON BOTH UPPER AND LOWER ARMS. DO NOT REMOVE NUTS FULLY.

4.REMOVE THE UPPER CONTROL ARM FROM THE SPINDLE, USE A BALL JOINT SPREADER IF NECESSARY. MAKE SURE THE FLOOR JACK IS SUPPORTING THE WEIGHT OF THE CONTROL ARM BEFORE ATTEMPTING TO REMOVE. NEXT REMOVE THE SPINDLE WITH THE BRAKE ASSEMBLY FROM THE LOWER BALL JOINT.
NOTE: DO NOT ALLOW THE BRAKE LINE TO BE PULLED OR ALLOW THE SPINDLE TO HANG FROM THEM. THIS CAN DAMAGE OR BREAK THE LINE. USE A WIRE TO SUPPORT THE SPINDLE.

5.REMOVE THE BOLT FROM THE BOTTOM OF THE SHOCK AND THE NUT FROM THE TOP. DISCARD THE STOCK SHOCK. YOU WILL REPLACE WITH THE PROPER LOWERED SHOCK. REMOVE THE NUT AND WASHER FROM THE BOTTOM END LINK ON THE SWAY BAR.

6. FULLY REMOVE THE CONTROL ARM BOLTS AND THEN REMOVE THE CONTROL ARM.

7. NEXT ON SOME APPLICATIONS YOU WILL HAVE TO TAKE YOUR STOCK LOWER CONTROL ARM AND HAVE THE BALL JOINT PRESSED OUT AND INSTALL THEM IN THE NEW LOWERED CONTROL ARM.

8. NOW REINSTALL THE NEW ARM AND OTHER FRONT LOWERING COMPONENTS IN THE REVERSE ORDER.

Typical Upper/Lower Control Arm Installation Instructions for Air Bags

(Click on picture of part to purchase.)

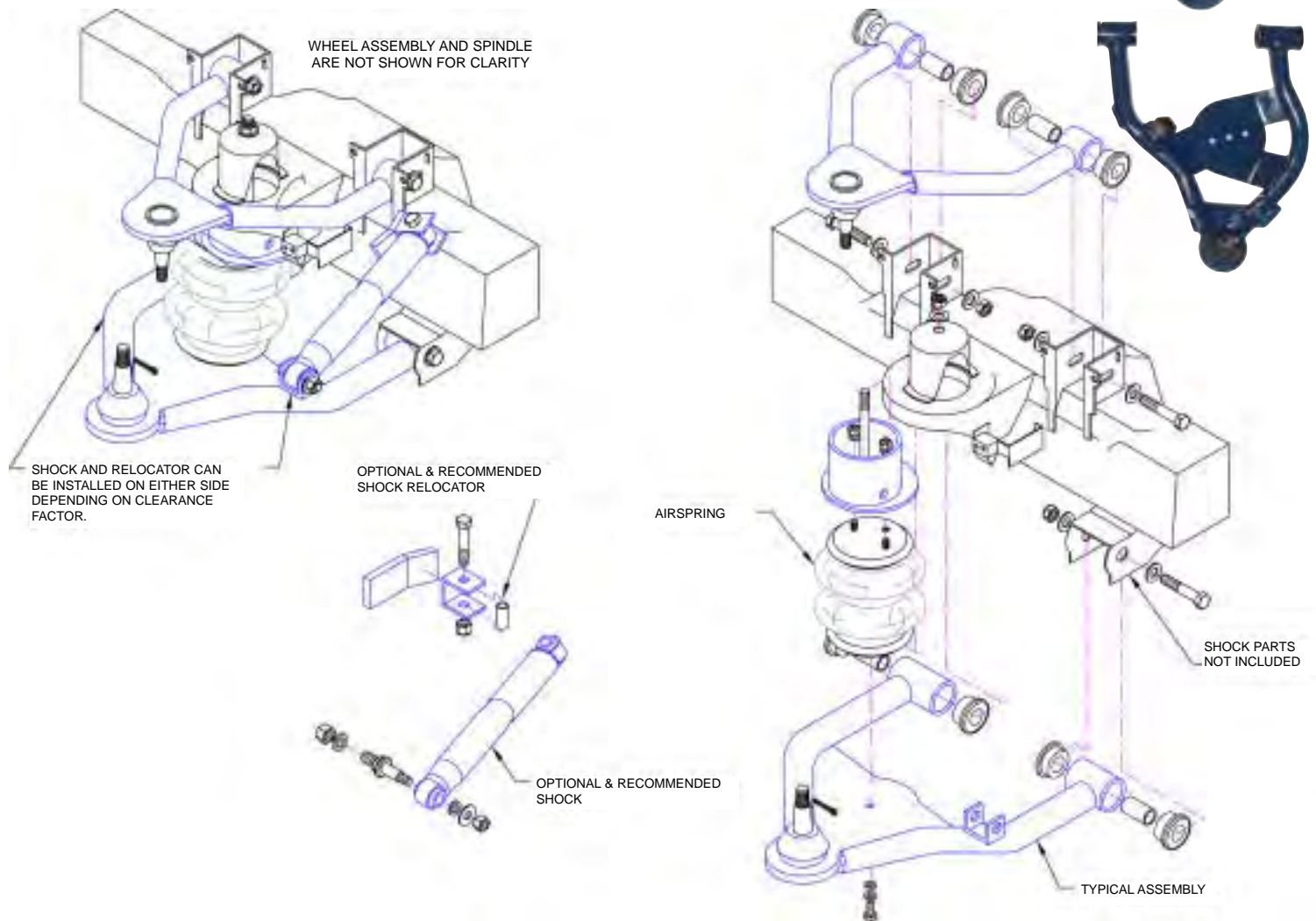

1. ONCE JACK STANDS ARE PLACED UNDER THE FRAME REMOVE THE FRONT TIRES . REMOVE THE COTTER PIN THE THE TIE ROD END. LOOSEN NUT AND REMOVE.

PLACE FLOOR JACK UNDER LOWER CONTROL ARM FOR SUPPORT. REMOVE COTTER PINS FROM THE LOWER AND UPPER BALL JOINTS.

3.LOOSEN BALL JOINT NUTS ON BOTH UPPER AND LOWER ARMS. DO NOT REMOVE NUTS FULLY.

4.REMOVE THE UPPER CONTROL ARM FROM THE SPINDLE, USE A BALL JOINT SPREADER IF NECESSARY. MAKE SURE THE FLOOR JACK IS SUPPORTING THE WEIGHT OF THE CONTROL ARM BEFORE ATTEMPTING TO REMOVE. NEXT REMOVE THE SPINDLE WITH THE BRAKE ASSEMBLY FROM THE LOWER BALL JOINT.

NOTE: DO NOT ALLOW THE BRAKE LINE TO BE PULLED OR ALLOW THE SPINDLE TO HANG FROM THEM. THIS CAN DAMAGE OR BREAK THE LINE. USE A WIRE TO SUPPORT THE SPINDLE.

5.REMOVE THE BOLT FROM THE BOTTOM OF THE SHOCK AND THE NUT FROM THE TOP. DISCARD THE STOCK SHOCK. YOU WILL REPLACE WITH THE PROPER LOWERED SHOCK. REMOVE THE NUT AND WASHER FROM THE BOTTOM END LINK ON THE SWAY BAR.

6. FULLY REMOVE THE CONTROL ARM BOLTS AND THEN REMOVE THE CONTROL ARM.

7. NEXT ON SOME APPLICATIONS YOU WILL HAVE TO TAKE YOUR STOCK LOWER CONTROL ARM AND HAVE THE BALL JOINT PRESSED OUT AND INSTALL THEM IN THE NEW LOWERED CONTROL ARM.

8. NOW REINSTALL THE NEW ARM AND OTHER FRONT LOWERING COMPONENTS IN THE REVERSE ORDER.