

Typical Coil Over Installation Instructions

(Click on picture of part to purchase.)

1. USING JACK STANDS JACK UP VEHICLE AND REMOVE WHEELS.

2. REMOVE ENTIRE SHOCK ASSEMBLY.

3. USING A SPRING COMPRESSOR, CAREFULLY REMOVE THE UPPER STRUT MOUNT AND SPRING FROM THE SHOCK.

4. REMOVE FACTORY DUST CAP AND BUMP STOP FROM STRUT.

5. INSTALL THREADED SLEEVE WITH HEX LOCKING SCREWS ON THE SHOCK.

6. TIGHTEN HEX SCREWS EVENLY ON TO THE SHOCK ASSEMBLY.

7. INSTALL SPRING ON THE SHOCK ASSEMBLY

8. INSTALL FACTORY SHOCK PISTON WASHER.

9. REINSTALL SHOCK ASSEMBLY TO OEM SPECIFICATIONS AND APPLY TO VEHICLE THE SAME WAY IT WAS TAKEN OFF.

10. SET ADJUSTMENT PERCHES TO DESIRED HEIGHT AND LOCK ADJUSTERS IN PLACE WITH SUPPLIED WRENCHES.

11. REPEAT PROCEDURE WITH OTHER SHOCKS.

12. IF ANOTHER DESIRED HEIGHT IS NEEDED, REPEAT STEP (1) AND UNLOCK THE ADJUSTERS USING THE SUPPLIED WRENCHES AND ADJUST THE SPRING PERCHES UP OR DOWN UNTIL DESIRED HEIGHT IS FOUND.

COILOVER.PDF

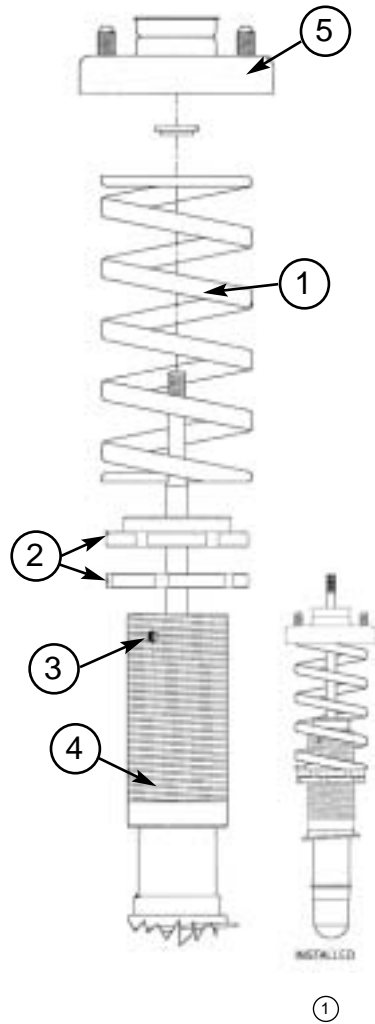

YEAR/MODEL	SPRING		ADJUSTABLE SPRING PERCH	SET SCREW .250-28		COILOVER THREADED SLEEVE		SPRING HAT	
	FRONT	REAR		FRONT	REAR	FRONT	REAR	FRONT	REAR
HONDA AND ACURA									
86-89 ACCORD	MEDIUM	SHORT	STANDARD	.500	.500	4.50	6.375	NO	NO
90-97 ACCORD	MEDIUM	LONG	STANDARD	.500	.500	5.00	8.00	NO	NO
98-xx ACCORD	EX-LONG	EX-LONG	STANDARD	.500	.500	3.50	4.00	NO	NO
88-00 CIVIC	MEDIUM	MEDIUM	STANDARD	.500	.500	.500	.500	NO	NO
90-01 INTEGRA	MEDIUM	MEDIUM	STANDARD	.500	.500	.500	.500	NO	NO
91-XX VIGOR	MEDIUM	LONG	STANDARD	.500	.500	.500	8.00	NO	NO
NISSAN									
91-94 SENTRA	MEDIUM	MEDIUM	STANDARD	.250	.250	4.00	4.00	.875	.562
95-XX SENTRA	MEDIUM	MEDIUM	STANDARD	.250	.250	5.00	3.00	.875	.562
95-XX 200SX	MEDIUM	MEDIUM	STANDARD	.250	.250	5.00	3.00	.875	.562
90-96 300ZX	MEDIUM	MEDIUM	STANDARD	.250	.500	3.00	2.62	.562	NO
MITSUBISHI									
95-98 GALANT	LONG	MEDIUM	STANDARD	.250	.500	3.50	3.00	.562	.562
95-99 ECLIPSE	LONG	MEDIUM	STANDARD	.250	.500	3.50	3.00	.562	.562
CHRYSLER									
95-00 SEBRING COUPE	LONG	MEDIUM	STANDARD	.250	.500	3.50	3.00	.562	.562
DODGE									
95-XX AVENGER	LONG	MEDIUM	STANDARD	.250	.500	3.50	3.00	.562	.562
VOLKS									
85-97 JETTA	LONG	LONG	STANDARD	.250	.5400	3.50	3.50	.875	.562
85-97 GOLF	LONG	LONG	STANDARD	.250	.5400	3.50	3.50	.875	.562
85-97 GTI	LONG	LONG	STANDARD	.250	.5400	3.50	3.50	.875	.562
TOYOTA									
88-92 COROLLA	LONG	SHORT	STANDARD	.250	.250	4.25	3.50	.875	.875

USE SPACER

DIAGRAM #4