

'TICK' MARKS MUST BE ON BEARING SIDE OF PISTON

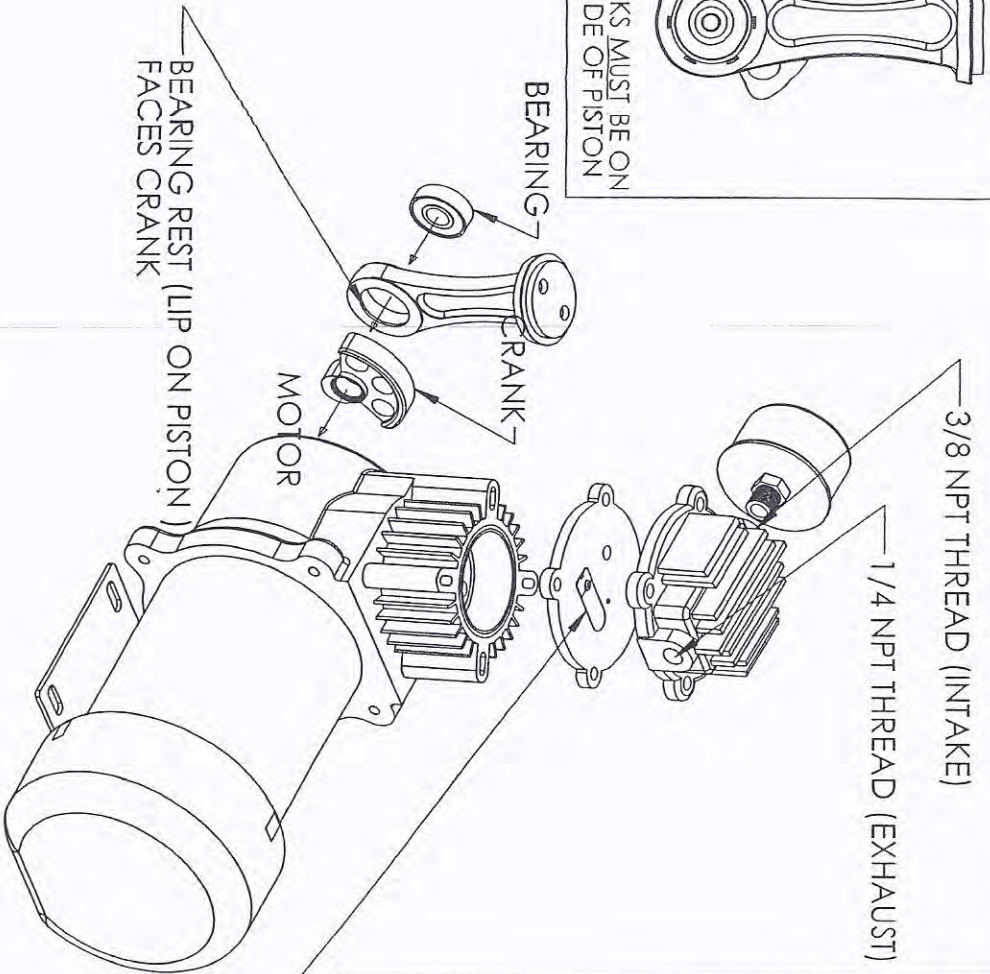

3/8 NPT THREAD (INTAKE)

1/4 NPT THREAD (EXHAUST)

BEARING REST (LIP ON PISTON) FACES CRANK

TOWARD EXHAUST

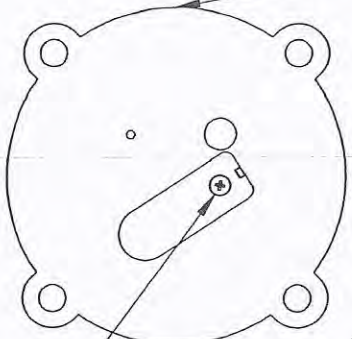

TOWARD INTAKE

IT IS THE RESPONSIBILITY OF THE CUSTOMER TO MAKE SURE THE SET SCREW ON THE REED VALVE DOES NOT COME INTO CONTACT WITH THE TOP OF THE PISTON

NO PREPARED COMMERCIAL DRAWINGS CONTAINED IN THIS DRAWING ARE THE SOLE PROPERTY OF AIAI/STRIE / CHASSIS TECH. ANY REPRODUCTION IN PART OR AS A WHOLE WITHOUT THE WRITTEN PERMISSION OF AIAI/STRIE / CHASSIS TECH IS PROHIBITED.

COMPRESSOR HEAD CAN BE ROTATED 180 DEGREES

DO NOT ROTATE COMPRESSOR HEAD 90 DEGREES

BRASS REED MUST FACE UPWARD TOWARD COMPRESSOR HEAD AND MUST BE ORIENTED TOWARD EXHAUST PORT (SEE ILLUSTRATION)

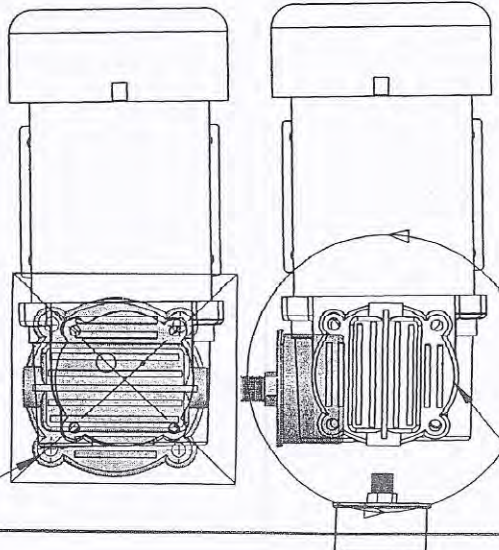

UNLESS OTHERWISE SPECIFIED:		NAME	DATE
DIMENSIONS ARE IN INCHES		DAVAIN	RSD 4/27/2011
TOLERANCES:		CHECKED	
ANGULAR MATCH	BEND 1	ENG APPR	
TWO PLACE DECIMAL	10:01	MFG APPR	
THREE PLACE DECIMAL	10:05		
INTERPRET DIMENSIONS TO BREAKING PER:			
MATERIAL		COMMENTS	
FINISH			
DO NOT SCALE DRAWING		SIZE	REV
Z:\COMPRESSOR BRACKET\		A	DWG. NO DC7500N/STRUCTURAL
			A

TITLE: COMPRESSOR/ PISTON INSTRUCT

