

Typical Lift Spindle

Installation Instructions

(Click on picture of part to purchase.)

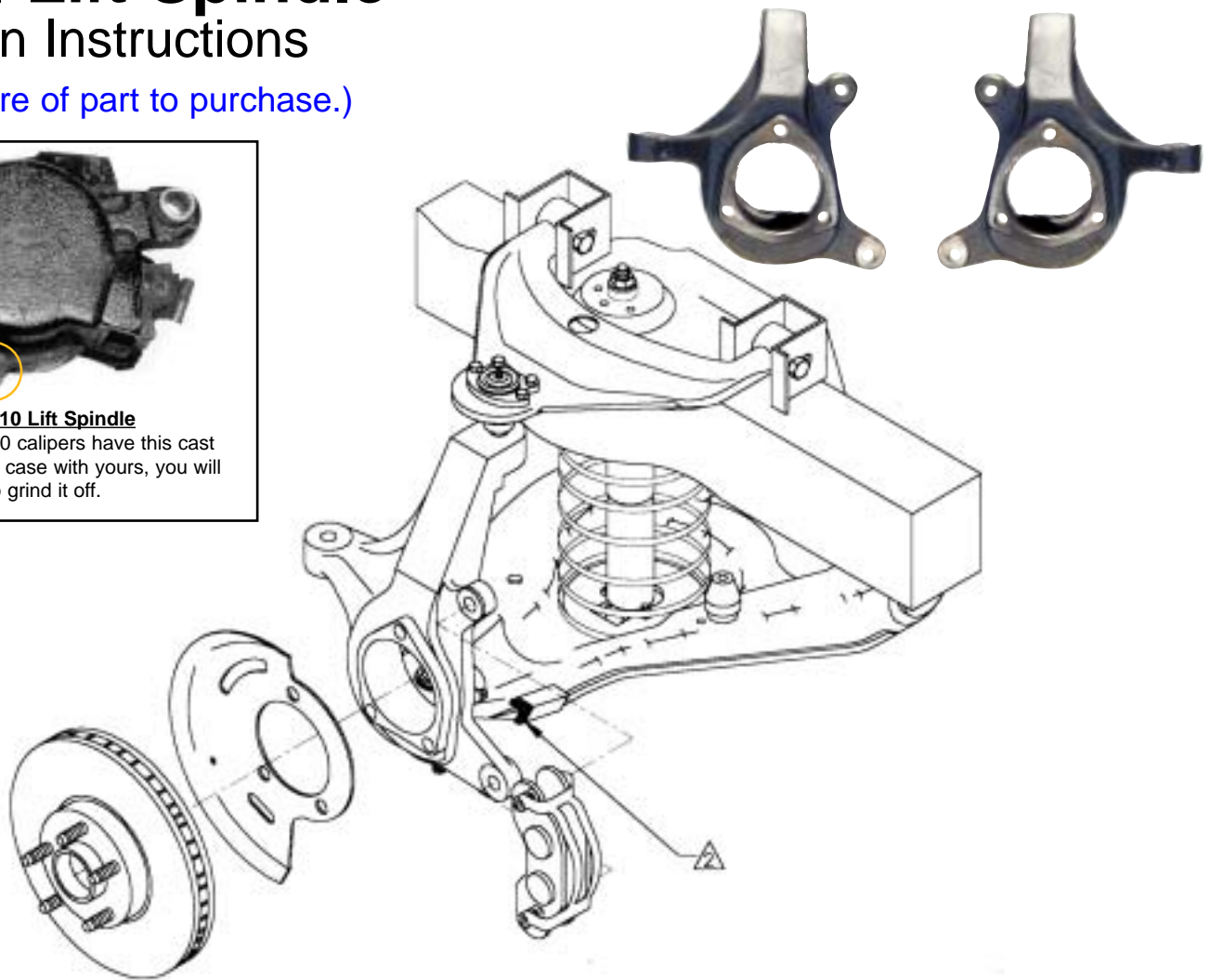
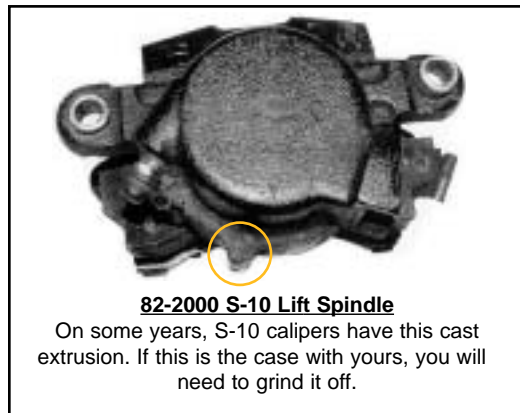

All parts are not shown for clarity

TO REMOVE STOCK SPINDLES:

1. RAISE THE FRONT OF THE VEHICLE AND PLACE FLOOR STAND UNDER THE FRONT LIFT POINTS. DO NOT PLACE FLOOR STANDS UNDER THE LOWER CONTROL ARMS BECAUSE SPRING TENSION IS NEEDED TO ASSIST IN BREAKING THE BALL JOINT.
2. REMOVE CALIPERS , & SUPPORT WITH A PIECE OF WIRE TO PREVENT DAMAGE TO THE BRAKE LINE.
3. REMOVE HUB DISC ASSEMBLY.
4. REMOVE BOLTS ATTACHING SPLASH SHIELDS TO KNUCKLE.
5. REMOVE TIE ROD ENDS FROM KNUCKLE AND KNUCKLE SEAL.
6. REMOVE BALL JOINT STUDS FROM KNUCKLE.

TO INSTALL NEW SPINDLES:

1. SET NEW LIFT SPINDLE OVER THE BALL JOINT STUD IN THE LOWER CONTROL ARM, ATTACH THE UPPER CONTROL ARM BALL JOINT, AND INSTALL THE CASTLE NUTS.
2. TIGHTEN TO FACTORY SPECS (9 FT. LBS.) AND SECURE WITH NEW COTTER PINS.
3. INSTALL SPINDLE SEAL.
4. INSTALL SPLASH SHIELD.
5. INSERT TIE ROD INTO SPINDLE AND TIGHTEN TO FACTORY SPECS. INSTALL COTTER PIN
6. INSTALL HUB DISC ASSEMBLY AND ADJUST WHEEL BEARING.
7. INSTALL DISC BRAKE CALIPER.